

To receive product information, register your product online. It's quick and easy!

Log on to http://www.chaneyinstrument.com/product_reg.htm

LIMITED ONE YEAR WARRANTY

Chaney Instrument Company warrants that all products it manufactures to be of good material and workmanship and to be free of defects if properly installed and operated for a period of one year from date of purchase. REMEDY FOR BREACH OF THIS WARRANTY IS EXPRESSLY LIMITED TO REPAIR OR REPLACEMENT OF DEFECTIVE ITEMS. Any product which, under normal use and service, is proven to breach the warranty contained herein within ONE YEAR from date of sale will, upon examination by Chaney, and at its sole option, be repaired or replaced by Chaney. In all cases, transportation costs and charges for returned goods shall be paid for by the purchaser. Chaney hereby disclaims all responsibility for such transportation costs and charges. This warranty will not be breached, and Chaney will give no credit for products it manufactures which shall have received normal wear and tear, been damaged, tampered, abused, improperly installed, damaged in shipping, or repaired or altered by others than authorized representatives of Chaney.

THE ABOVE-DESCRIBED WARRANTY IS EXPRESSLY IN LIEU OF ALL OTHER WARRANTIES, EXPRESS OR IMPLIED, AND ALL OTHER WARRANTIES ARE HEREBY EXPRESSLY DISCLAIMED, INCLUDING WITHOUT LIMITATION THE IMPLIED WARRANTY OF MERCHANTABILITY AND THE IMPLIED WARRANTY OF FITNESS FOR A PARTICULAR PURPOSE. CHANEY EXPRESSLY DISCLAIMS ALL LIABILITY FOR SPECIAL, CONSEQUENTIAL OR INCIDENTAL DAMAGES, WHETHER ARISING IN TORT OR BY CONTRACT FROM ANY BREACH OF THIS WARRANTY. SOME STATES DO NOT ALLOW THE EXCLUSION OR LIMITATION OF INCIDENTAL OR CONSEQUENTIAL DAMAGES, SO THE ABOVE LIMITATION OR EXCLUSION MAY NOT APPLY TO YOU. CHANEY FURTHER DISCLAIMS ALL LIABILITY FROM PERSONAL INJURY RELATING TO ITS PRODUCTS TO THE EXTENT PERMITTED BY LAW. BY ACCEPTANCE OF ANY OF CHANEY'S EQUIPMENT OR PRODUCTS, THE PURCHASER ASSUMES ALL LIABILITY FOR THE CONSEQUENCES ARISING FROM THEIR USE OR MISUSE. NO PERSON, FIRM OR CORPORATION IS AUTHORIZED TO ASSUME FOR CHANEY ANY OTHER LIABILITY IN CONNECTION WITH THE SALE OF ITS PRODUCTS. FURTHERMORE, NO PERSON, FIRM OR CORPORATION IS AUTHORIZED TO MODIFY OR WAIVE THE TERMS OF THIS PARAGRAPH, AND THE PRECEDING PARAGRAPH, UNLESS DONE IN WRITING AND SIGNED BY A DULY AUTHORIZED AGENT OF CHANEY. THIS WARRANTY GIVES YOU SPECIFIC LEGAL RIGHTS, AND YOU MAY ALSO HAVE OTHER RIGHTS WHICH VARY FROM STATE TO STATE.

For in-warranty repair, please contact:

Customer Care Department
Chaney Instrument Company
965 Wells Street
Lake Geneva, WI 53147

Chaney Technical Support
877-221-1252
Mon-Fri 8:00 a.m. to 4:45 p.m. CST

www.chaneyinstrument.com



This device complies with part 15 of the FCC rules. Operation is subject to the following two conditions:
1- This device may NOT cause harmful interference, and
2- This device must accept any interference received, including interference that may cause undesired operation.

NOTE: This equipment has been tested and found to comply with the limits for a Class B digital device, pursuant to Part 15 of the FCC rules. These limits are

designed to provide reasonable protection against harmful interference in a residential installation. This equipment generates, uses and can radiate radio frequency energy and, if not installed and used in accordance with the instructions, may cause harmful interference to radio communications. However, There is no guarantee that interference will not occur in a particular installation. If this equipment does cause harmful interference to radio or television reception, which can be determined by turning the equipment off and on, the user is encouraged to try to correct the interference by one or more of the following measures:

- Reorient or relocate the receiving antenna.
- Increase the separation between the equipment and the receiver.
- Connect the equipment into an outlet on a circuit different from that to which the receiver is connected.
- Consult the dealer or an experienced radio/TV technician for help.

NOTE: The manufacturer is not responsible for any radio or TV interference caused by unauthorized modifications to this equipment. Such modifications could void the user authority to operate the equipment.

Patent numbers: 5,978,738; 6,076,044; 6,597,990

ACURITE®
DESIGNED TO WORK FOR YOU™

Wireless Pool & Spa
Thermometer
model #00617

Instruction Manual



A. Main Unit



B. Wireless Sensor

Package Contents:

- (1) Main Unit (A) with stand
- (1) Wireless Sensor (B)

What You Need:

- Small Phillips Screwdriver
- (5) AA batteries

Thank You for purchasing this ACURITE® product. Please read this manual in its entirety to fully enjoy the benefits and features of this product. Please keep this manual for future reference.

NOTE: A clear film is applied to the LCD panels at the factory that must be removed prior to using this product. Locate the clear tabs and simply peel to remove.

THIS PRODUCT IS INTENDED TO BE USED AS A COMFORT AND CONVENIENCE SOLUTION, IT IS NOT INTENDED AS A POOL OR SPA SAFETY DEVICE. FOLLOW YOUR POOL OR SPA MANUFACTURERS INSTRUCTIONS FOR SAFE USE OF YOUR POOL OR SPA.

SECTION 1 • OVERVIEW OF FEATURES

MAIN DISPLAY UNIT

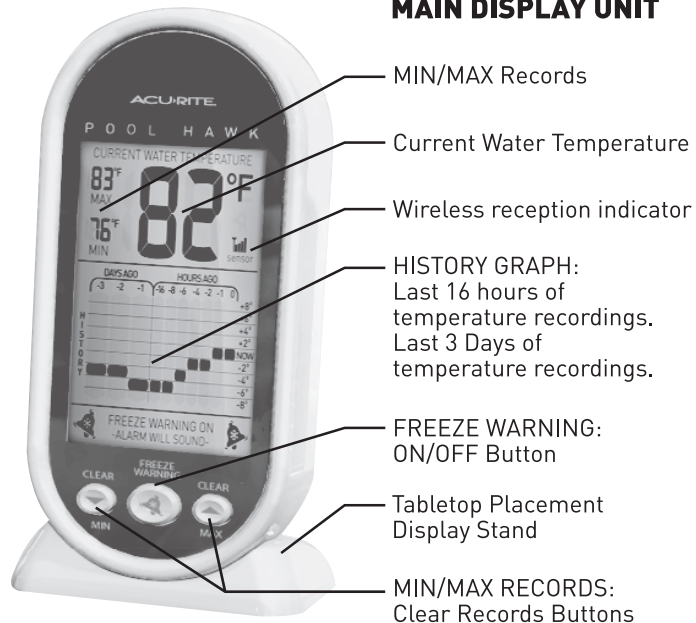

WIRELESS WATER TEMPERATURE SENSOR

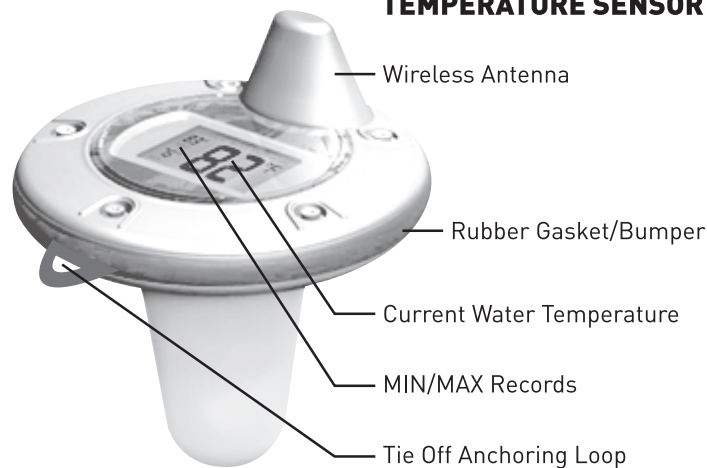

About the Main Display Unit

This Acurite® Pool & Spa Thermometer allows you to monitor the water temperature of your pool or spa from inside your house (up to 100 feet away). The pool and spa thermometer also features a history graph, which tracks temperature changes from 1 hour ago to 3 days ago. This allows you to monitor heating trends, which can assist in reducing your energy costs. The history graph also serves to give you an early warning when equipment is not heating properly. This thermometer also features a "FREEZE WARNING", which, when activated will alert you to the water temperature trending towards freezing (32°F/0°C). This can help to prevent costly freeze damage to your pool or spa equipment. NOTE: THE MAIN DISPLAY UNIT IS **NOT WATERPROOF**.

About the Wireless Sensor

This Acurite® Pool & Spa Thermometer features a wireless sensor that provides water temperature data and broadcasts this information to the main display unit. This wireless sensor uses 433mhz wireless communication, which is susceptible to interference from other electronic devices, metallic surfaces, and thick stone building materials. For best results, it should be placed within sight of the main display unit, and less than 100' away.

The wireless sensor contains sensitive electronic components. Care must be taken during setup and use to make certain the unit is not dropped or struck. The wireless sensor is sealed with a heavy-duty rubber gasket, which must be evenly tightened to maintain a water tight seal. Do not open case near water.

SECTION 2 • SETUP

A/B/C Wireless Selection

To allow for more than one weather station and wireless sensor network to be used in close proximity, the main unit and the wireless sensor have a small switch labeled "A B C" within the battery compartments. This switch selects one of 3 wireless modes to use, and both switches MUST be set in matching positions (either A, B, or C) for wireless communication to take place successfully.

Battery Choice & Temperature Range

Extended periods of cold temperatures (below -4°F / -20°C) can cause alkaline batteries to function improperly. This will cause the outdoor wireless sensor to stop transmitting temperature readings. Use lithium batteries in these low temperature conditions to ensure continued operation for wireless sensors placed outdoors. NOTE: Rechargeable batteries are not recommended due to higher operating voltages.

LITHIUM BATTERIES	-40°F (-40°C)	(70°C) 158°F
ALKALINE BATTERIES	-4°F (-20°C)	(70°C) 158°F

Install Batteries

NOTE: Install all batteries in both units within a 6 minute period to ensure proper wireless functionality. **Always install batteries into the wireless sensor FIRST.**

Wireless Sensor - 2 "AA" Batteries Required (not included)

- 1 REMOVE TOP SECTION OF SENSOR BY REMOVING THE 5 SCREWS ON TOP**

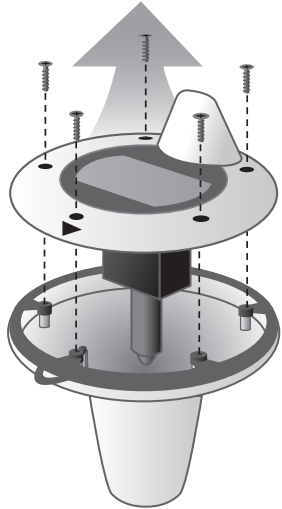

- 2 SLIDE THE BATTERY DOOR OPEN AND INSTALL 2 "AA" BATTERIES**

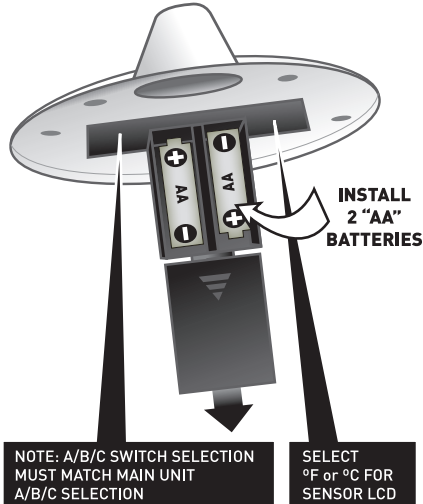

NOTE: A/B/C SWITCH SELECTION MUST MATCH MAIN UNIT A/B/C SELECTION

SELECT °F or °C FOR SENSOR LCD

- 3 LINE UP THE ARROWS ON BOTH TOP AND BOTTOM SECTIONS OF THE SENSOR**

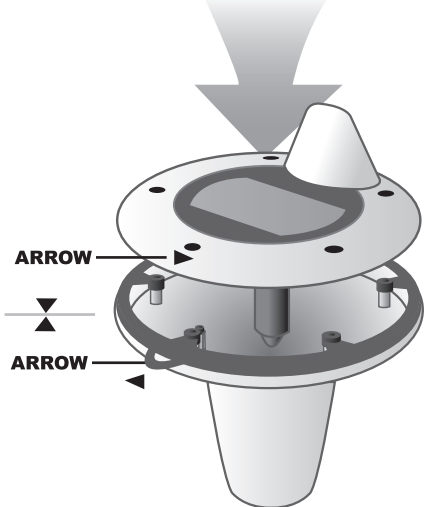

- 4 GENTLY REINSTALL THE 5 SCREWS AND TIGHTEN IN THE ORDER SHOWN BELOW**

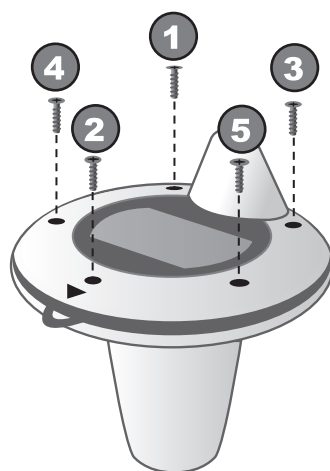

DO NOT OVERTIGHTEN SCREWS!

Install Batteries

NOTE: Install all batteries in both units within a 6 minute period to ensure proper wireless functionality. **Always install batteries into the wireless sensor FIRST.**

Main Unit - 3 "AA" Batteries Required (not included)

- 1 REMOVE BATTERY COMPARTMENT COVER AND INSTALL 3 FRESH "AA" BATTERIES**

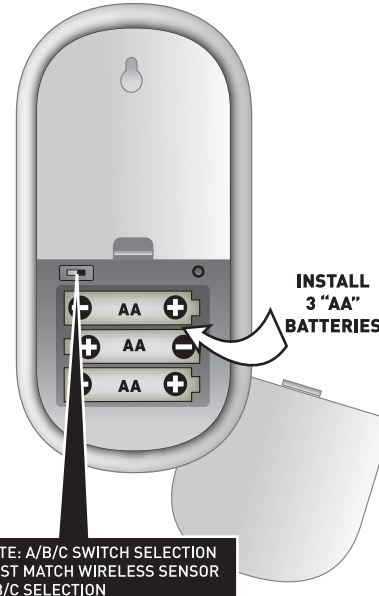

NOTE: A/B/C SWITCH SELECTION MUST MATCH WIRELESS SENSOR A/B/C SELECTION

- 3 REPLACE BATTERY COMPARTMENT COVER**

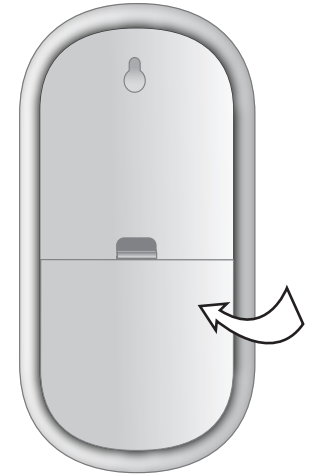

PLEASE DISPOSE OF OLD OR DEFECTIVE BATTERIES IN AN ENVIRONMENTALLY SAFE WAY AND IN ACCORDANCE WITH YOUR LOCAL LAWS AND REGULATIONS.

BATTERY SAFETY: Clean the battery contacts and also those of the device prior to battery installation. Remove batteries from equipment which is not to be used for an extended period of time. Follow the polarity (+/-) diagram in the battery compartment. Promptly remove dead batteries from the device. Dispose of used batteries properly. Only batteries of the same or equivalent type as recommended are to be used. **DO NOT** incinerate used batteries. **DO NOT** dispose of batteries in fire, as batteries may explode or leak. **DO NOT** mix old and new batteries or types of batteries (alkaline/standard). **DO NOT** use rechargeable batteries. **DO NOT** recharge non-rechargeable batteries. **DO NOT** short-circuit the supply terminals.

Setup is Now Complete

The wireless sensor will soon send a signal to the main unit and the two units will be synchronized. It may take a few minutes for synchronization to be complete. If both or one of the units appear to be functioning improperly, refer to the troubleshooting section in this manual.

SECTION 3 • OPERATION

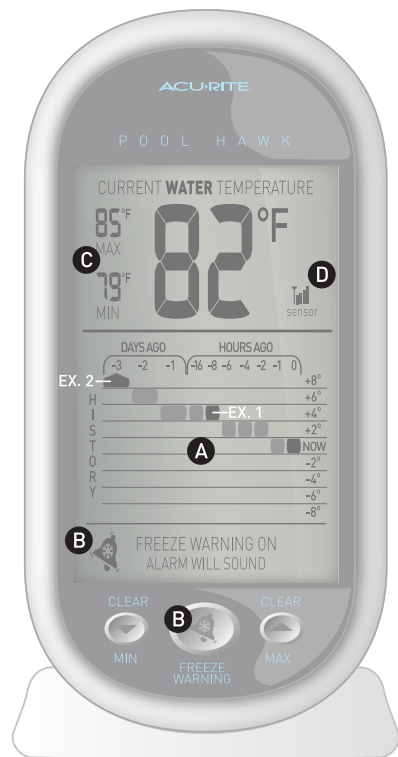

A History Graphing

The history graphing function automatically records and stores temperature readings and displays them in a graphical format. This will help to save on energy costs, as you can get a better idea of when to heat up the pool or spa for future use. This feature will also help you monitor if your pool/spa equipment is heating properly.

HOURS AGO= the temperature reading, sampled at the hour change.

DAYS AGO= the temperature AVERAGE for that day

NOW= Graphical reference point of the current temperature reading

EXAMPLE 1: 8 hours ago, the temperature was 4°F warmer than it is right now.

EXAMPLE 2: 3 days ago, the temperature was at least 8°F warmer than it is right now.

B Freeze Warning Alarm

When activated, the freeze warning alarm alerts you when the temperature drops below 40°F (4°C) to help prevent freeze damage to pool and spa heating equipment. The alarm will beep up to 1 minute if the alarm is not turned off. The alarm icon on the display will continue to flash for up to 10 hours if not turned off.

The Freeze Warning Alarm requires a few things to operate properly:

1. Batteries must be fresh and both units must be operational
2. The wireless signal must be received by the main unit
3. The wireless sensor must be located in the water of the pool or spa that you wish to be alerted about freezing conditions occurring

SECTION 3 • OPERATION

C MIN/MAX Memory

This wireless pool & spa thermometer features a MIN/MAX memory feature which records the MINIMUM and MAXIMUM temperature readings.

The MINIMUM and MAXIMUM records are displayed at all times to the left of the current water temperature on the display.

To **clear** the MIN recorded value, press the **“CLEAR MIN”** button. Dashes will display and you will hear an audible “beep” to confirm you have cleared the MIN value.

To **clear** the MAX recorded value, press the **“CLEAR MAX”** button. Dashes will display and you will hear an audible “beep” to confirm you have cleared the MAX value.

D Wireless Signal Reception Icon

The main unit has a signal reception icon near the temperature display area. If most or all four of the bars are present, wireless reception is good and no action is required. If there are a low number of “bars” present, you may experience temperature inaccuracy. In either case, you may need to relocate the main unit or the wireless sensor.



This product uses 433mhz wireless radio frequency (RF) for communication. RF is susceptible to interference from a wide variety of materials and electronic devices. The FCC requires that such interference be allowed to occur in some cases. You may occasionally experience a brief disruption in communication. In the event of a communication disruption (low bars), this product is designed to search and acquire the wireless temperature sensor signal again automatically.

If the communication disruption continues for more than 12-24 hours, there may be electronic or physical interference present. You may need to relocate the main display unit or the wireless water temperature sensor so that both units are CLOSER to each other.

See the troubleshooting section in the back of this manual for more information.

SECTION 4 • PLACEMENT

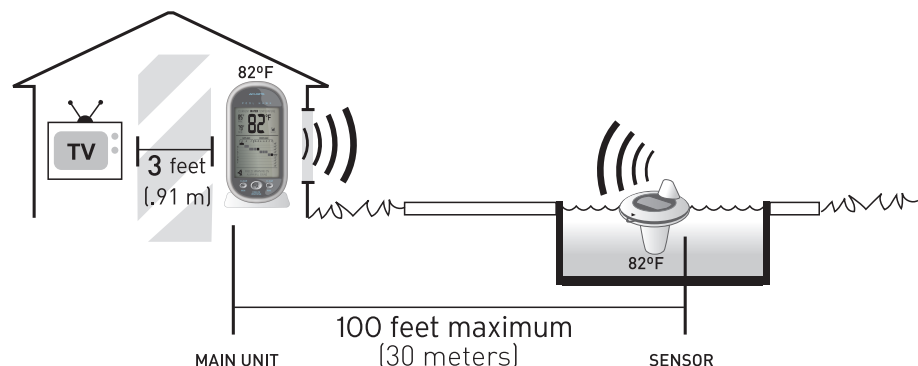

Now that setup is complete and you understand how to operate the wireless pool & spa thermometer, you must choose a location to place the wireless sensor and the main unit. The wireless sensor **MUST** be placed less than 100 feet (30 meters) away from the main unit.

This wireless pool & spa thermometer uses radio frequency for communication, which is susceptible to interference from other electronic devices and large metallic items or thick walls. Always place both units at least 3 feet (.91 m) away from appliances (TV, microwave, radios, etc.) or objects that may interfere with the wireless communication (large metal surfaces, thick stone walls, etc.).

Please **USE EXTREME CARE** when handling the wireless sensor and the main unit. The wireless sensor contains sensitive electronic components. Care must be taken during setup and when considering placement to make certain the unit is not dropped or struck with any falling debris from trees or structures.

USE CAUTION when utilizing tools or equipment for placing the main unit or the wireless sensor. Enlist the help of another individual when necessary.



Placement of Main Unit

Place the main unit in a dry area free of dirt and dust. The main display unit is **NOT WATERPROOF** and is designed for indoor use. There are two placement options for the main unit. You may hang the main unit on a wall using the integrated hang hole. Alternatively, you may place the main unit on a table top or other flat surface using the included detachable table top display stand.



Placement of Wireless Sensor

The wireless sensor **MUST BE PLACED IN THE WATER** to observe the water temperature and relay the temperature to the main unit display. The wireless sensor must be placed less than 100 feet (30 m) from the main unit.

MAKE CERTAIN THAT THE SENSOR IS SEALED PROPERLY AND THAT ALL 5 SCREWS ARE SUFFICIENTLY AND EVENLY TIGHTENED BEFORE PLACING THE WIRELESS WATER TEMPERATURE SENSOR INTO THE POOL OR SPA. (SEE DIAGRAM 4 ON PAGE 4)

A tie off anchoring loop has been integrated into the wireless sensor for your convenience. The sensor should be secured to a ladder or other structure to prevent it from drifting out of wireless range with the main display unit. Secure the sensor utilizing the integrated tie off loop and a length of waterproof cord or rope (not included).

CAUTION: when utilizing the tie off anchoring loop, make certain that all children are observed in the pool or spa and that the cord or rope used does not present a choking or entanglement risk.

NOTE: The wireless sensor contains sensitive electronic components. Care must be taken during setup and use to make certain the unit is not dropped or struck. The wireless sensor is sealed with a heavy-duty rubber gasket, which must be evenly tightened to maintain a water tight seal.

Measurement Ranges

Temperature

Wireless Sensor: 32°F to 122°F / 0°C to 50°C

Specifications

Power Requirements

Main Unit: 3 x "AA" alkaline or lithium batteries

Wireless Sensor: 2 x "AA" alkaline or lithium batteries

Wireless Communication

433 MHz Radio Frequency-Transmission every 18 seconds

Set Wireless ID

This wireless thermometer uses long range 433mhz radio frequency for communication.

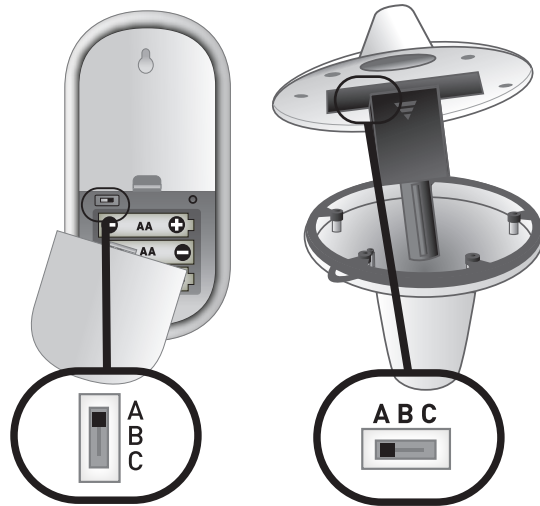

In the event that you have reception problems due to interference, both the main unit and the wireless sensor have a selectable wireless ID. The ID switches are located within the battery compartments of the main unit and the wireless sensor.

You may choose A, B or C; but both the **main unit** and the **wireless sensor ID's must match** for successful synchronization.



Both wireless ID's must match

Troubleshooting

Problem	Possible Solution
<p>Bad Wireless Sensor Reception</p> 	<p>Relocate the main unit and/or the wireless sensor. Both units must be within 100 feet (30 m) from each other. Make sure both units are placed at least 3 feet (.91 m) from other electronic appliances and devices that may interfere with the wireless communication (such as TV's, microwaves, computers etc). NOTE: It may take up to 20 minutes for the main unit to re-synchronize with the sensor when batteries are replaced. Use lithium batteries in sensor when temperature is below -4°F (-20°C).</p>
<p>No Wireless Sensor Data (no communication)</p> 	<p>If wireless reception is bad (no bars), see "Bad Reception" section above. The wireless ID setting on each unit must match for all units to communicate properly. See "Set Wireless ID" on the previous page.</p>
<p>Main Unit Display Not Working</p>	<p>Make certain that the batteries are installed correctly and that they are contacting the terminals. Make certain all contacts are clean. The batteries may need replacing.</p>



Please DO NOT return product to the retail store.
For technical assistance and product return information, please call
Technical Support: **877-221-1252** Mon. - Fri. 8:00 A.M. to 4:45 P.M.

www.chaneyinstrument.com